



**DESIGN & APPLICATION ENGINEERS S.A.**  
ILEKTRAS 2 & KIMIS AVENUE, 15122 MAROUSSI  
TEL +30 (210)6412233, 2810122 FAX +30 (210)6454825  
e-mail: civeng@mhxme.gr web: www.mhxme.com

Einzelheiten



DATUM

24/04/2026

Pg

1/6

### **Cut & Cover at Polymilos Egnatia**

#### **Zeit-Studie**

2000

#### **Budget (€)**

800,000.00

#### **Arbeitgeber**

DOMI OE

#### **Besitzer**

EGNATIA ODOS SA

#### **Position**

Polymilos Kozani

Design of a cut and cover tunnel of Egnatia Odos Σ8 from CH. 24+168 to CH. 24+280, section 5.1 Lefkopetra-Polymilos Kozani. Length 112.50 m, width 12.50 m.



**DESIGN & APPLICATION ENGINEERS S.A.**  
ILEKTRAS 2 & KIMIS AVENUE, 15122 MAROUSSI  
TEL +30 (210)6412233, 2810122 FAX +30 (210)6454825  
e-mail: civeng@mhxme.gr web: www.mhxme.com

Einzelheiten



DATUM

24/04/2026

Pg

2/6

### General Overview





**DESIGN & APPLICATION ENGINEERS S.A.**  
ILEKTRAS 2 & KIMIS AVENUE, 15122 MAROUSSI  
TEL +30 (210)6412233, 2810122 FAX +30 (210)6454825  
e-mail: civeng@mhxme.gr web: www.mhxme.com

Einzelheiten



DATUM

24/04/2026

Pg

3/6

*Construction phase*





**DESIGN & APPLICATION ENGINEERS S.A.**  
ILEKTRAS 2 & KIMIS AVENUE, 15122 MAROUSSI  
TEL +30 (210)6412233, 2810122 FAX +30 (210)6454825  
e-mail: civeng@mhxme.gr web: www.mhxme.com

Einzelheiten



DATUM

24/04/2026

Pg

4/6

*Construction phase*





**DESIGN & APPLICATION ENGINEERS S.A.**  
ILEKTRAS 2 & KIMIS AVENUE, 15122 MAROUSSI  
TEL +30 (210)6412233, 2810122 FAX +30 (210)6454825  
e-mail: civeng@mhxme.gr web: www.mhxme.com

Einzelheiten



DATUM

24/04/2026

Pg

5/6

*Construction phase*





Section Reinforcement Drawing

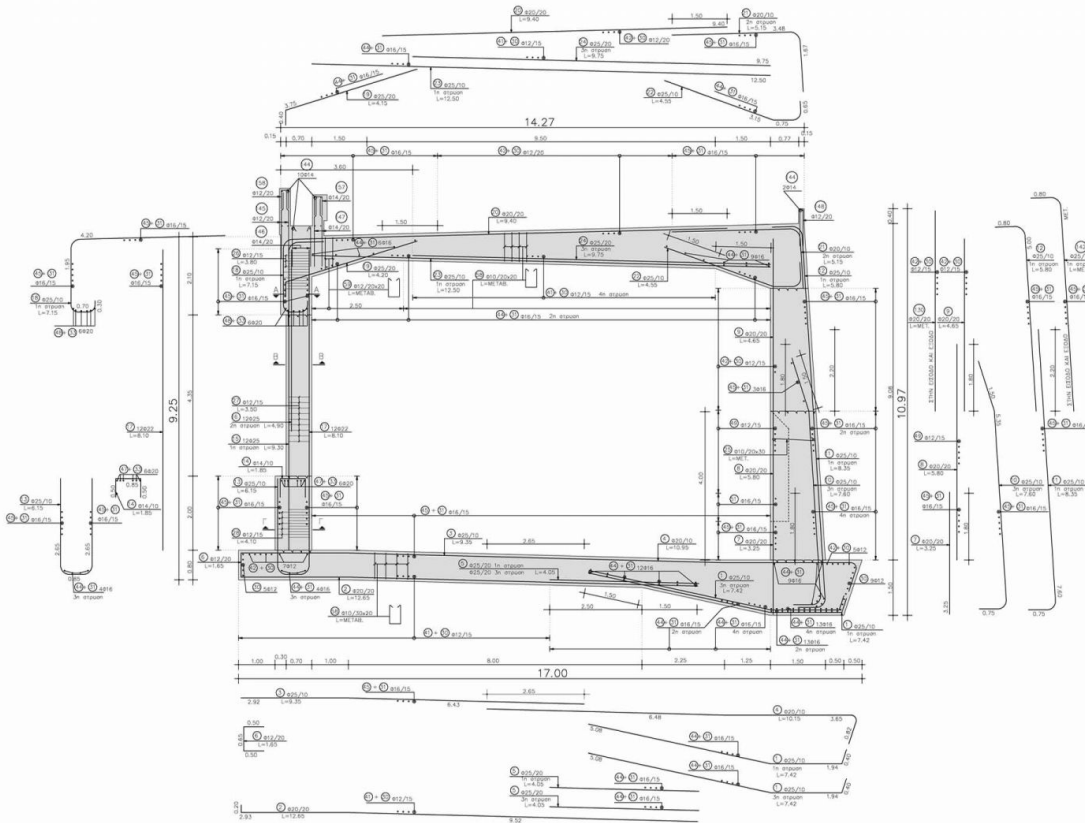

ΕΓΚΑΡΣΙΟΣ ΟΠΛΙΣΜΟΣ ΔΙΑΤΟΜΗΣ  
ΚΑΙ 1:50 ΣΤΗ ΘΕΣΗ ΤΟΥ ΥΠΟΣΤΥΛΙΑΤΟΣ